



LCS Series

Plastic Pictogram Exit Sign

Type: _____

Project/Location: _____

Contractor: _____

Prepared By: _____

Date: _____

Model No.: _____

FEATURES

- Energy efficient, long-life white LEDs consuming 4.2W at normal operation
- Back plate included for single face wallmount installation. No canopy required
- Dual voltage input capability 120/347VAC
- Selection of AC/DC, 6 to 24VDC or Self-Powered using a 3.6V Nickel-Cadmium battery
- Automatic, temperature compensated, pulse type charger
- Low voltage disconnect prevents over discharge of battery
- Automatic brownout protection
- Battery lock-out prevents discharge during installation
- Comes standard with three pictogram legends for direction selection
- Red LED charger monitor
- Injection-molded off-white thermoplastic ABS housing
- Fast and easy installation with snap-together design
- Ceiling, wall or end mount installation
- Meets or exceeds CSA 22.2 No.141-15 certified
- Comes standard with one (1) year warranty



POWER CONSUMPTION AND UNIT RATING

MODEL	AC SPECS			DC SPECS	
AC/ DC-remote	120/347VAC	0.5/0.4 A	4.2/3.6W	6 to 24VDC	Less than 1.5W
Self-Powered				Ni-Cd battery	120 minutes

*NOTE: The LCS Family cannot be combined with other Lumacell products on the same emergency A.C. circuit.

DIMENSIONS

Dimensions are approximate and subject to change.

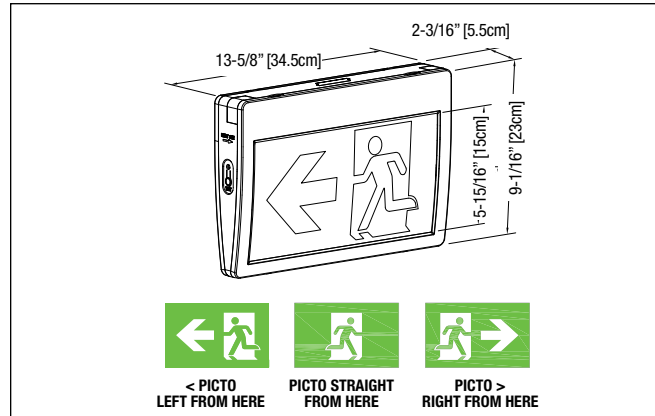

ORDERING INFORMATION

SERIES	VOLTAGE
LCS	-U= 120/347VAC, 6 to 24VDC -SP= 120/347VAC, Self-Powered (120 mins)

EXAMPLE: LCS-SP



LCSC Series

Plastic Pictogram Combination Unit

FEATURES

- Energy efficient, long-life white LEDs consuming 4.2W at normal operation
- Back plate included for single face wallmount installation. No canopy required
- Dual voltage input capability 120/347VAC
- 3.6V Nickel-Cadmium battery provides minimum 90 minutes of emergency lighting
- Fully adjustable LED glare-free lens
- 3.6V 1W long life LED light source, 6000K
- Adjustable light heads for forward or backward lighting
- Automatic, temperature compensated, pulse type charger
- Low voltage disconnect prevents over discharge of battery
- Automatic brownout protection
- Battery lock-out prevents discharge during installation
- Comes standard with three pictogram legends for direction selection
- Red LED charger monitor
- Injection-molded off-white thermoplastic ABS housing
- Fast and easy installation with snap-together design
- Ceiling, wall or end mount installation
- Meets or exceeds CSA 22.2 No.141-15 certified
- Comes standard with one (1) year warranty



DIMENSIONS

Dimensions are approximate and subject to change.

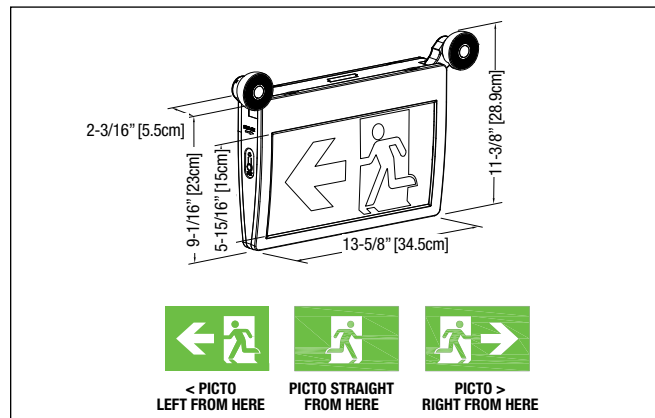

POWER CONSUMPTION AND UNIT RATING

MODEL	AC SPECS			DC SPECS	
LCSC-2LEDWR	120/347VAC	0.5/0.4 A	4.2/3.6W	Ni-Cd battery	Min. 90 minutes

*NOTE: The LCS Family cannot be combined with other Lumacell products on the same emergency A.C. circuit.

ORDERING INFORMATION

SERIES	VOLTAGE	LAMP
LCSC	Blank= 120/347VAC	-2LEDWR= 2X 1W LED

EXAMPLE: LCSC-2LEDWR