

SLEXO-SLSRO

EDGE LIT

NRCan C860 Registered
LED 120/347VAC Input



Approvals:
CSA Certified to C22.2 #141.15 and C860



DESCRIPTION

The SLEXO/SLSRO series of architectural edgelit signs provides interiors with a clean, distinguished appearance. Ideal for use in facilities required to meet current building code requirements such as airports or government buildings and institutions. Mounting is available as a universal wall, ceiling or end mount. The SLEXO/SLSRO series is available in AC only, AC/DC and internally self-powered versions.

CIRCUITRY

- LED ultra bright light source
- 120/347VAC Input, field selectable
- 6/12/24VDC Input, field selectable
- 90 minutes emergency duration is optional
- 120VAC EXIT 1.8W power consumption
- 347VAC EXIT 2.0W power consumption
- 120VAC SORTIE 1.9W power consumption
- 347VAC SORTIE 2.1W power consumption

MECHANICAL

- High clarity, clear acrylic faceplates with a choice of backings: clear (Single face), white or mirrored
- Screened on exit lettering/stencil
- Field installable peel on/off universal directional chevrons/arrows
- Housing is made of high end extruded aluminum
- All electronics and faceplate are factory installed for rapid and simple installation
- White powder coat finish or brushed aluminum are standard, other finishes and colours optional

SURFACE CEILING

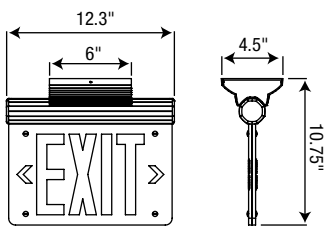

SURFACE WALL

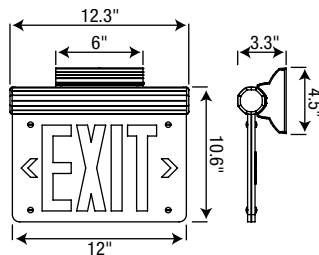

END MOUNT

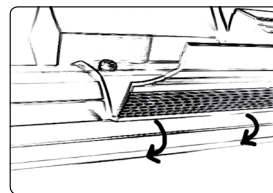
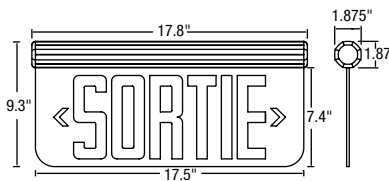
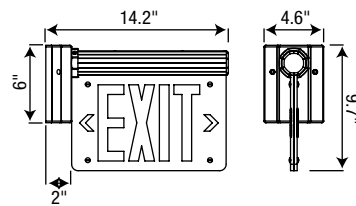

**UNIVERSAL WALL
OR CEILING**
simply slide the
canopy to position

ORDERING GUIDE

Series	Nbr of faces	Mounting	Letter/Face colour	Colour	DC Voltage
SLEXO - Exit	1 - Single face	CM - Surface ceiling	CR - Red on clear (single face only)	WH - White	UDC - Universal DC backup voltage 6, 12 or 24VDC selectable
SLSRO - Sortie	2 - Double face	WM - Surface wall	WR - Red on white	BK - Black	NDC - AC only
		EM - Surface end	MR - Red on mirror	BA - Brushed aluminum	IB - Self-powered for 90 minutes
		SP - Pendant mount			